

2-M12 Taps 14 (P.C.D. 268, 180°EQ. Spaced)  
Tap Drill 117.5

φ720  
Minimum Diameter

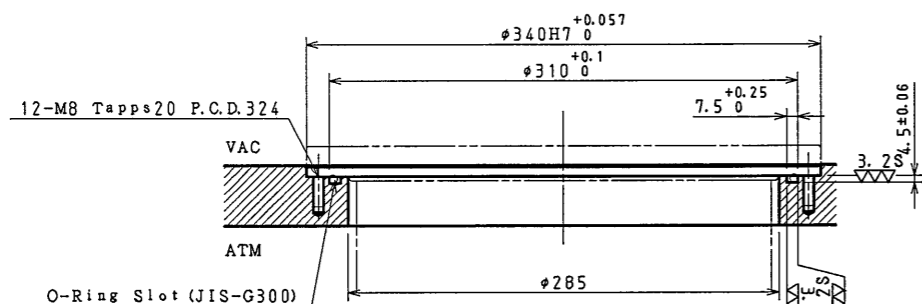

Chamber Attachment Seat Details  
(S=1:5)

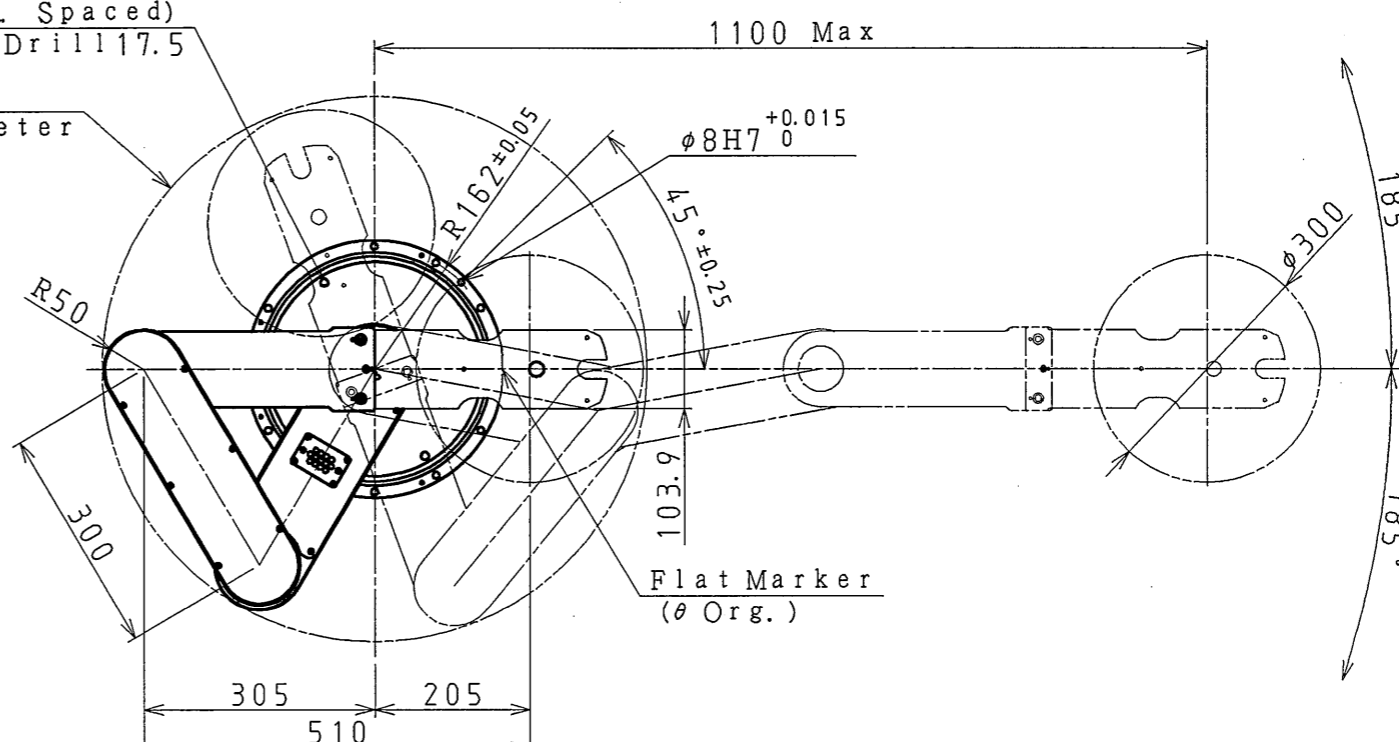
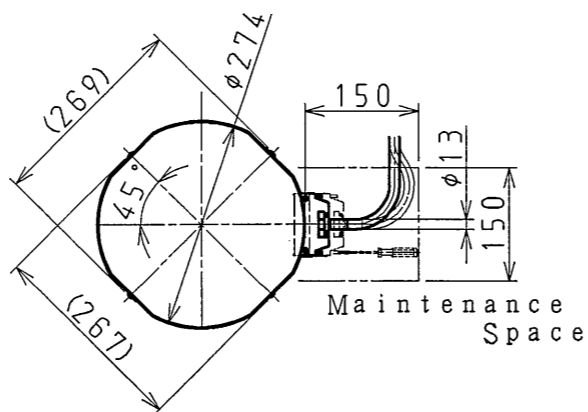
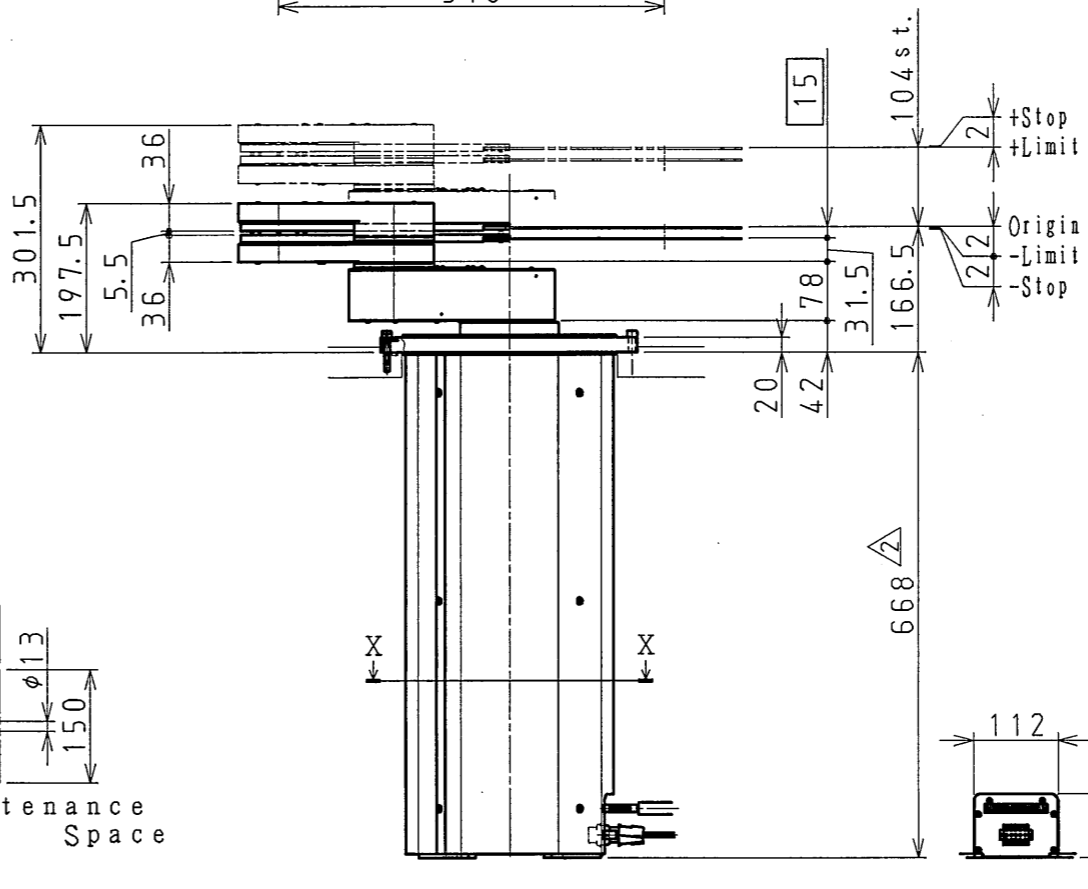

Section X-X

		<b>TAZMO</b>				MODEL	S0075
		SCALE	DRAW	DESIGN	CHECK	APPROVE	NAME
		1:10	2007.09.19	2007.09.19	2007.11.26	2007.11.26	Robot Dimension Drawing
Rev. No.	Description					No.	88041268
△	07/11/26 K. Saino: Revision of specification						

07117088

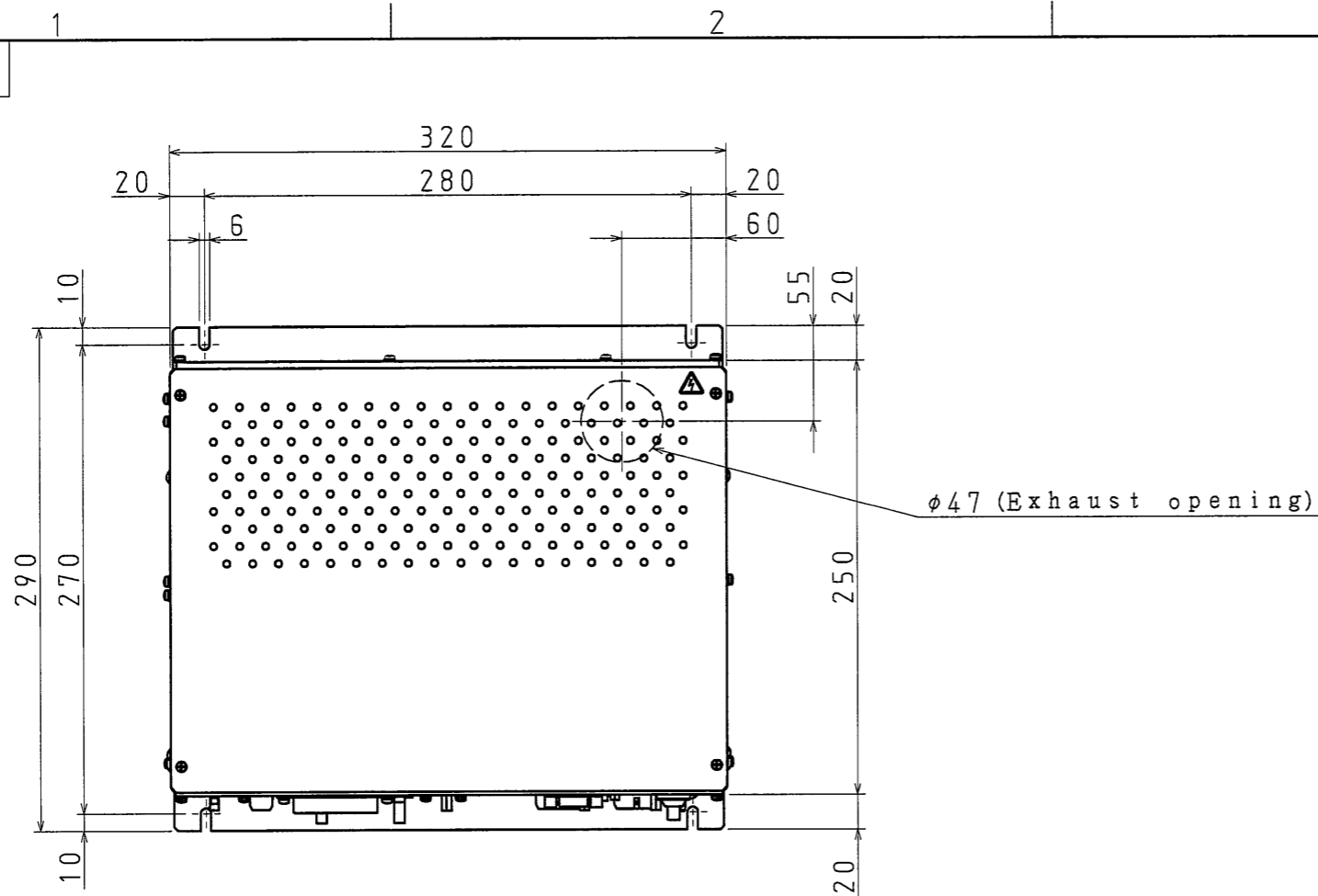

	DISPLAY NAME	FUNCTION
1	STATUS CODE	Status Code Indicator
2	RS485-2	Communication Connector
3	ROBOT	Robot Signal Line
4	RS232C	Communication Connector
5	RS485-1	Communication Connector
6	TEACHING	Teaching Pendant Connector
7	PARALLEL	Parallel Communication Connector
8	RS232C/RS485	RS-232C/RS-485 Switcher
9	CB3	Circuit Protector (DC24V 2A)
10	MOTOR1	Robot Power Line
11	MOTOR2	Robot Power Line
12	AC IN	Connector for Power Input (AC208V)
13	POWER	Power on/off Switch (AC208V 5A)
14	CB2	Circuit Protector (AC208V 2A)
15	SIRIAL	Serial Communication Connector (MCQ Connection)
16	S1	Parallel Communication Connector (Input, Host Connection, PLC)
17	S2	Parallel Communication Connector (Output, Host Connection, PLC)
18	CB5	Circuit Protector (DC24V 2A)
19	CB6	Circuit Protector (DC24V 1A)

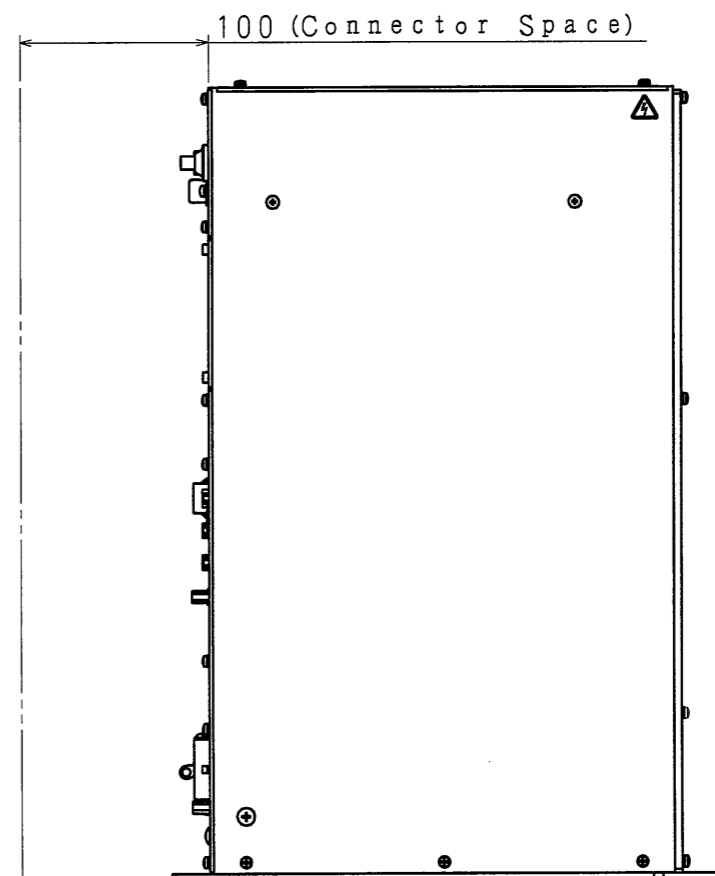
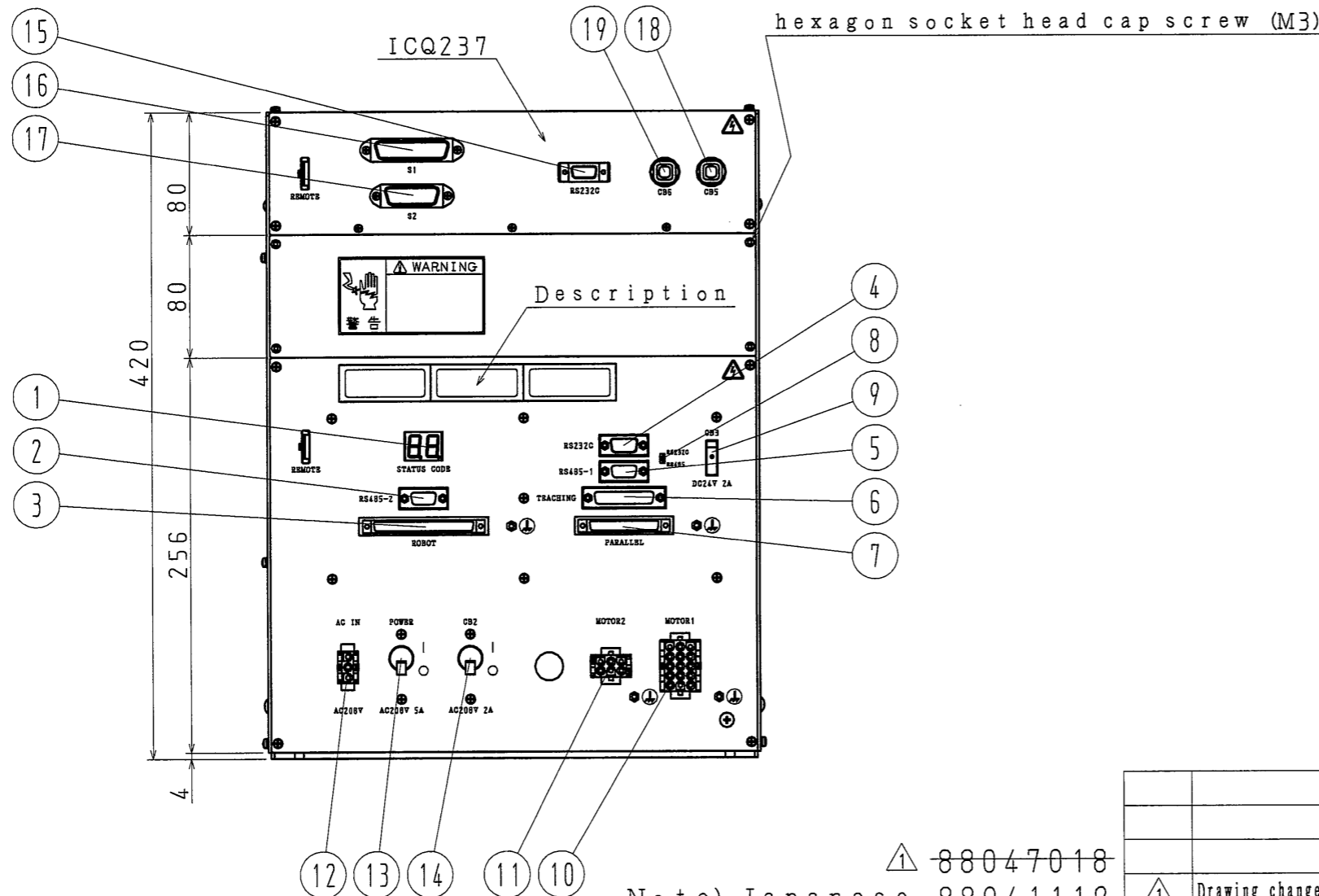

△ 88047018  
 Note) Japanese 88041119

		<b>TAZMO</b>				MODEL MCQ-N2+ICQ237	
SCALE	DRAW	DESIGN	CHECK	APPROVE	NAME	Controller outline drawing	CAD
1:4	2007.04.26	2007.04.26	27.05.01	07.5.1			
Rev. No.	Description		Korematsu Takashima Nishijima		No.		88041120